

SITE LOCATION PLAN - HERNE HILL VELODROME, 104 BURBAGE ROAD, LONDON, SE24 9HD

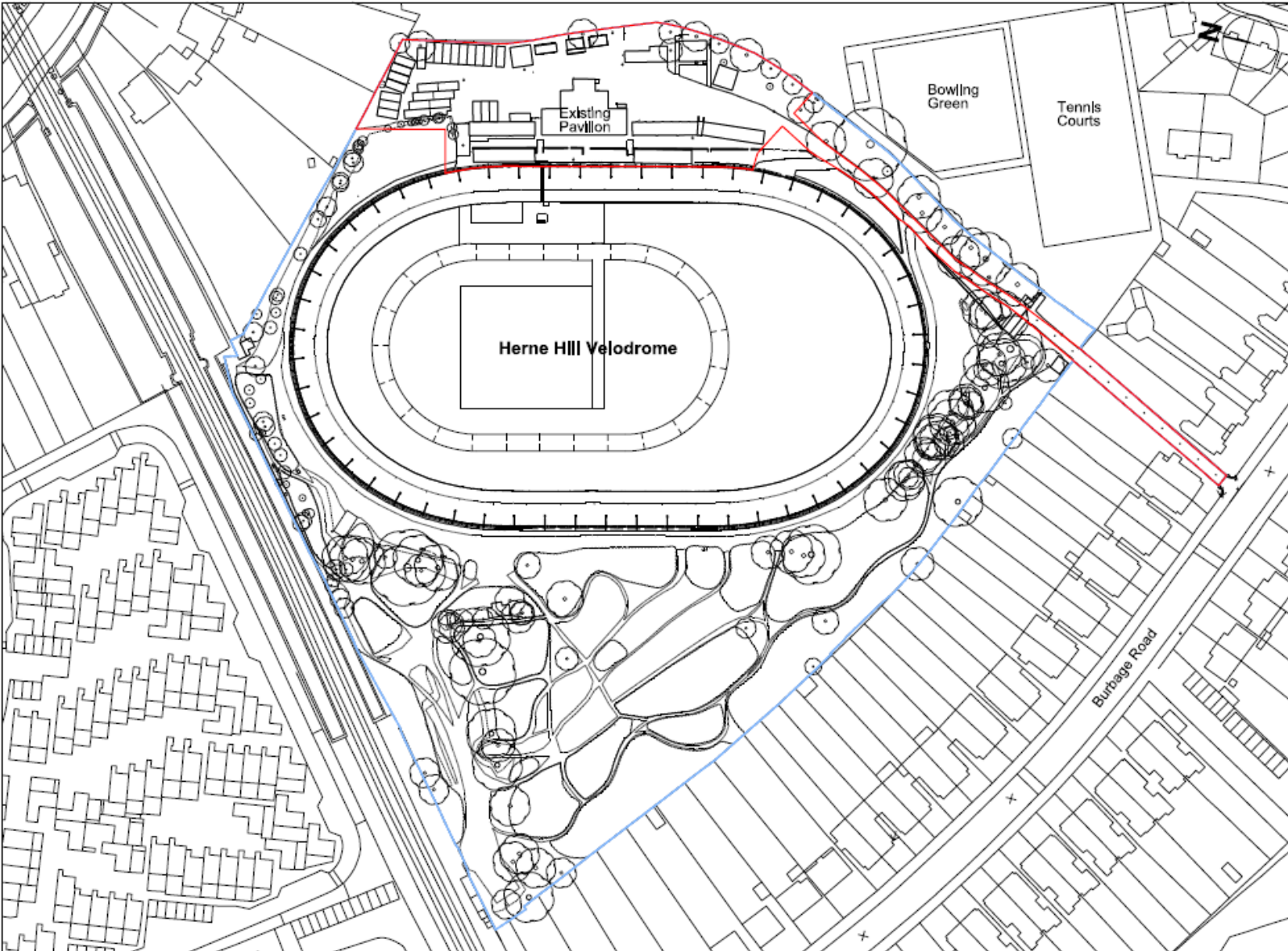

General Notes:

- G1 For Site and Grid setting out refer to A/HHV/3000
- G2 All dimensions to be checked on site
- G3 Any discrepancies between drawings to be reported to the Architect immediately.
- G4 All Levels are above ordnance datum (AOD)
 New Levels are shown thus: 1246.355
 Existing Levels are shown thus: EX+20.345
 Retained Existing Levels: EX+20.345
- G5 Use figured dimensions only; Do not scale from drawings, IF IN DOUBT, ASK.
- G6 Refer to Structural Engineers drawings for all structural and services information.
- G7 For tolerances see the Design Drawings and Specifications
- G8 For elements of work subject to Contractor's Design, this drawing is indicative of the visual & performance requirements only. The Contractor is responsible for the detailed design and co-ordination of the installation within the parameters defined in the specification, design drawings, contract terms and contract documents.
- G9 Room numbers are shown thus: 115
- G10 Door(D) & Window (W) References are shown thus: D-1
- G11 Clear height is shown thus (finished floor to finished soffit) 2750
- G12 T Sheet Reference shown thus IWS-01
- G13 Finishes are shown thus: WALL, CEILING, FLOOR, DOOR, WINDOW
- G14 Setting Out Points shown thus: SOP
- G15 Refer to A/HHV/9100 for T Sheet references, and to A/HHV/9102 for Architectural Specifications.

AREA = 0.495 hectares

